

CX 15

Point Source Speaker

Part number CX 15 L: 1007628

Part number CX 15 R: 1007629

Thanks to its 15" bass/mid-range driver, the CX 15 passive speaker provides a powerful bass foundation. Its multi-functional cabinet means it can be used as an FOH speaker, delay speaker or stage monitor – anywhere where a very high sound pressure level, high speech intelligibility and powerful bass reproduction are required.

Exceptional phase linearity, a wide dynamic range and a BEM-optimised high-frequency horn ensure a very precise dispersion pattern. When used as a monitor, the CX 15 is particularly suitable for very loud stage applications and can also reproduce low-frequency instruments perfectly.

Characteristics

- Passive 15"/1.4" full-range speaker
- Multi-functional cabinet
- Transparent resolution and very precise dispersion pattern thanks to Boundary Element Method-optimised high-frequency horn
- 4x NL4 speakon connectors
- Cabinet made of birch multiplex with resistant PU coating
- HK Audio DuoTilt Adapter
- Expandable with C SUB subwoofer models
- Suitable for sophisticated stage monitoring as well as a full-range speaker for small events

Applications

- Monitoring with sophisticated bass reproduction
- Full-featured front PA top
- Extremely high sound pressure levels in the near field (club use, electronic music)

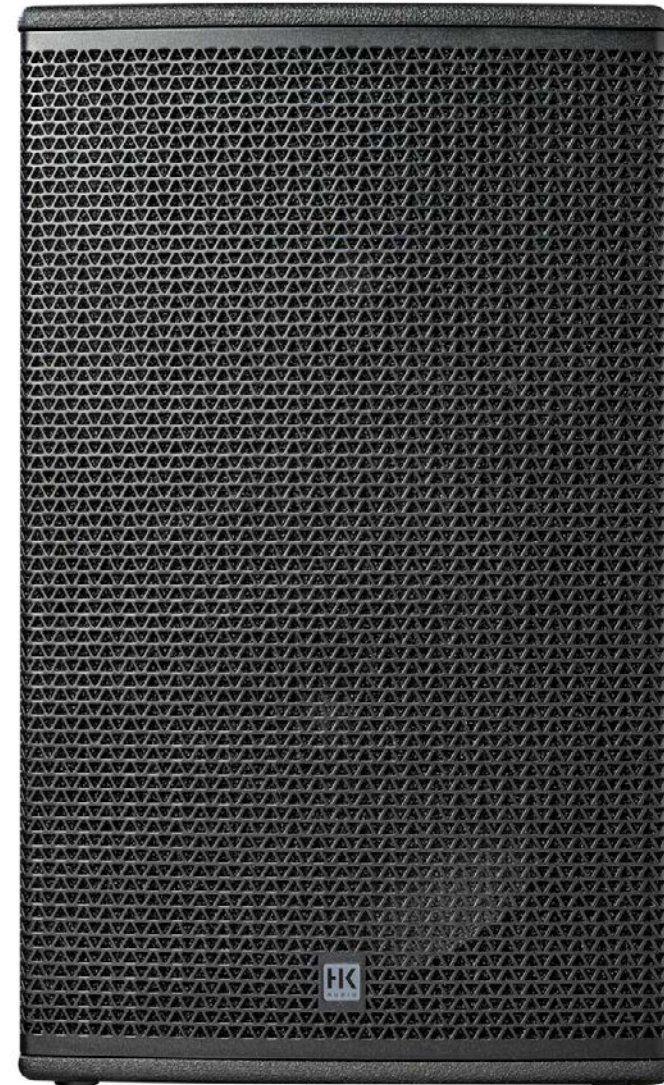

Technical data

CX 15 L/R	
Power-handling nominal (RMS)	700 W
Power-handling, program	1400 W
Frequency response +/-3 dB	69 Hz - 18 kHz
Frequency response -10 dB	55 Hz - 19 kHz
Sensitivity 1 W @ 1 m	99 dB (100 Hz - 10 kHz), full space
Max. SPL @ 10% THD (EN 60268-21:2019)	132 dB
Electrical impedance	8 ohms
Low/mid speaker	1x 15", 3.5" voice coil
HF Driver	1.4", 3" voice coil
Directivity	75° x 55°, rotatable CD Horn
Crossover frequency	1.2 kHz, 24 dB/oct.
Connections	4x Speakon NL4 (with sealing cap), pin assignment switch
Angles up	35°/55° (monitor / frontfill)
Pole mount	DuoTilt 3°/7°
Rigging points	10x M10, 1x Aeroquip
Carrying handles	4x recessed grip
Housing	Birch multiplex
Finish	PU coating black
Front grille	Steel front grill with anticorrosive coating, acoustic foam
Dimensions (WxHxD)	45,5 x 76 x 39,5 cm 17-29/32 x 29-59/64"
Weight	29.1 kg / 64.0 lbs

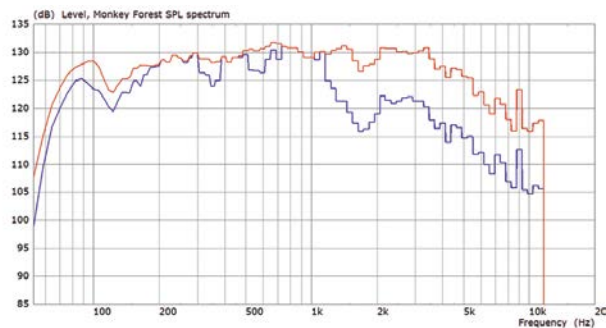

Max. SPL
(blue = 3 % THD, red = 10 % THD)

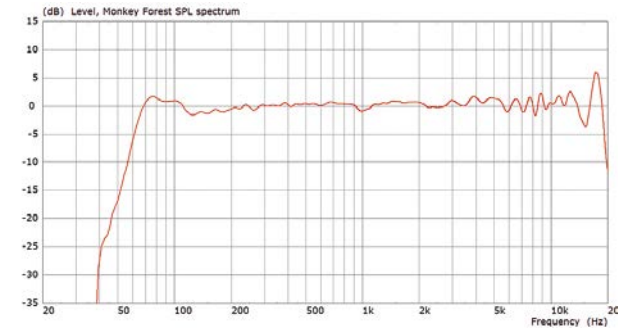

Frequency response (with controller)

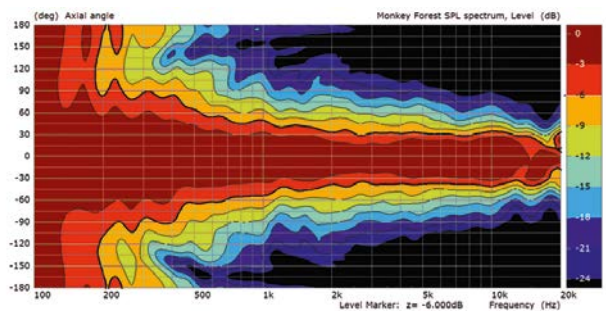

Horizontal directivity

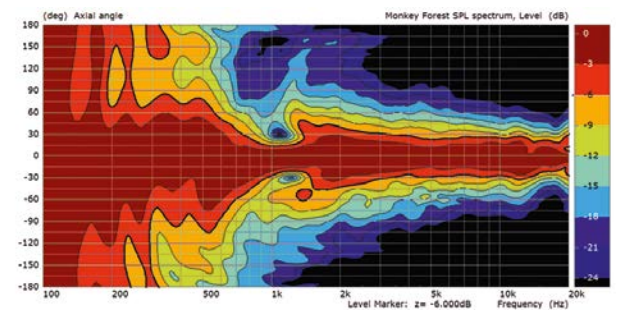

Vertical directivity

Accessories

TB-XNQ

Part number: 1007781

Universal tilt bracket for mounting the CX 15 on truss rods, ceilings, wall brackets, beams and on tripods.



AP-10B

Part number: 1007664

Optional attachment points for CX, for safe installation of the speakers on steel cables or chains.



Cover CX 15

Part number: 1007710

Padded, lockable transport protection cover for road-proof transportation of the CX 15.



Case 2CX15

Part number: 1007687

Optional flight cases in black for 2x CX 15.



CX 15 Point Source Speaker

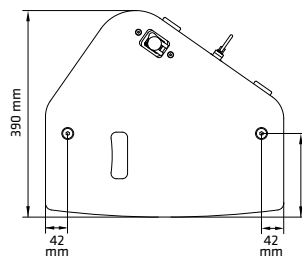
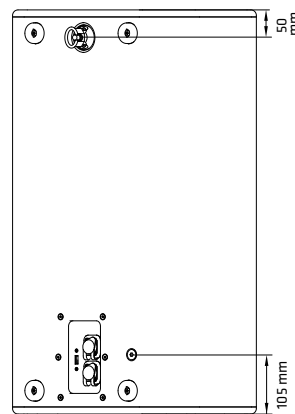
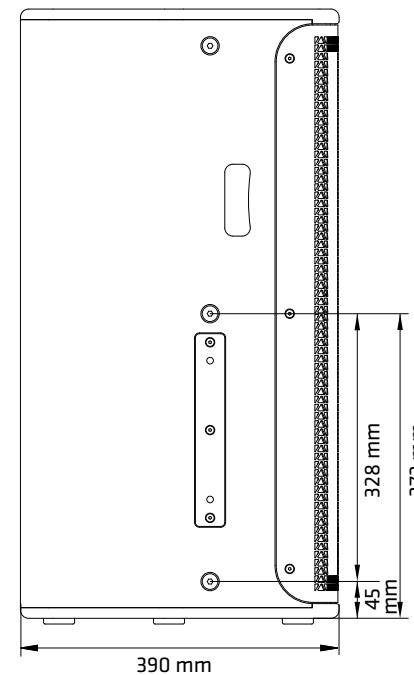
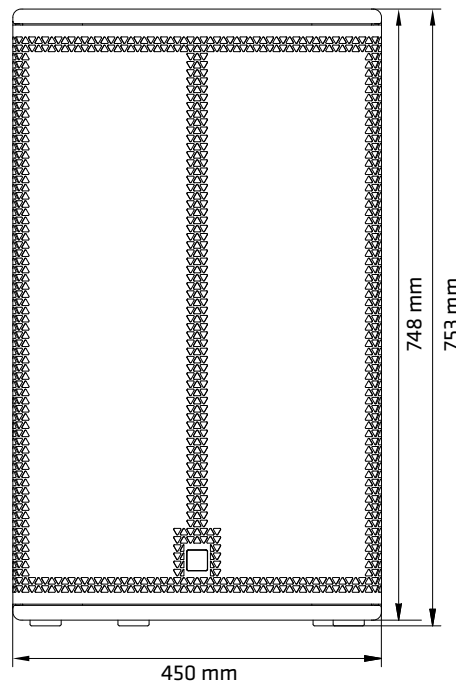

HK Audio
Postfach 1509
66595 St. Wendel, Germany

info@hkaudio.com
fax +49-68 51-905 215
www.pro.hkaudio.com